

Furnizor: **Sc Trivolt Distribution SRL**
Reg. com.: J23/3300/2016
CIF: RO36421140
Adresa: Strada Apusului nr 3 (primul
sens giratoriu Tehodor Pallady-
Autostrada Soarelui), Catelu, Ilfov
Banca: BRD
IBAN: RO34BRDE441SV13182234410

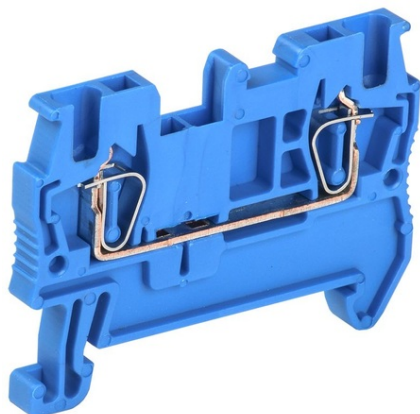

IEK SPRING BRIDA KPI 2V-1,5 17,5A ALBASTRU

Spring terminals are designed for permanent safe and compact connection of conductors of different cross sections in ordered distribution systems inside the electrical cabinets. Used for mounting phase, zero and protective conductors. The use of a spring clamping system makes the process of connecting conductors as simple and fast as possible. They are installed on a DIN rail. It is possible to connect the conductors of nominal cross-section both with cable tips and without preliminary treatment. The insulating casing is made of elastic and impact-resistant fire-resistant polyamide which has excellent resistance to aggressive environments and temperature. Wide range of accessories: plugs, marking plates, jumpers. Spring clamp provides a reliable gas-tight connection, improved vibration resistance and tightness. Connectable conductor cross section fine-strand without cable end sleeve: 1,5

Connectable conductor cross section solid-core: 0,2...2,5

Connectable conductor cross section multi-wired: 0,2...1,5

Rated current In: 17.5

Nominal rated voltage: 500

Type of electrical connection 1: EV005752

Type of electrical connection 2: EV005752

Connection position: EV001224

Number of levels: 1

Mounting method: EV005503

Material insulation body: EV000154

Operation temperature: -40...+85

Inflammability class of insulation material acc. with UL94: EV004429

Width/grid dimension: 4.2

Length: 49.3

Colour: EV000080

Number of poles: 1

Model: IEK_V0000471

Material housing: IEK V0000544

Pret: 2,39 lei (TVA inclus)

Detalii online: <https://www.materialeelectrice.ro/spring-brida-kpi-2v-1-5-17-5a-albastru-309378>